

Proposed Addition to JOHN F. KENNEDY ELEMENTARY SCHOOL

SPRING VALLEY C.C.S.D. No. 99
SPRING VALLEY, ILLINOIS

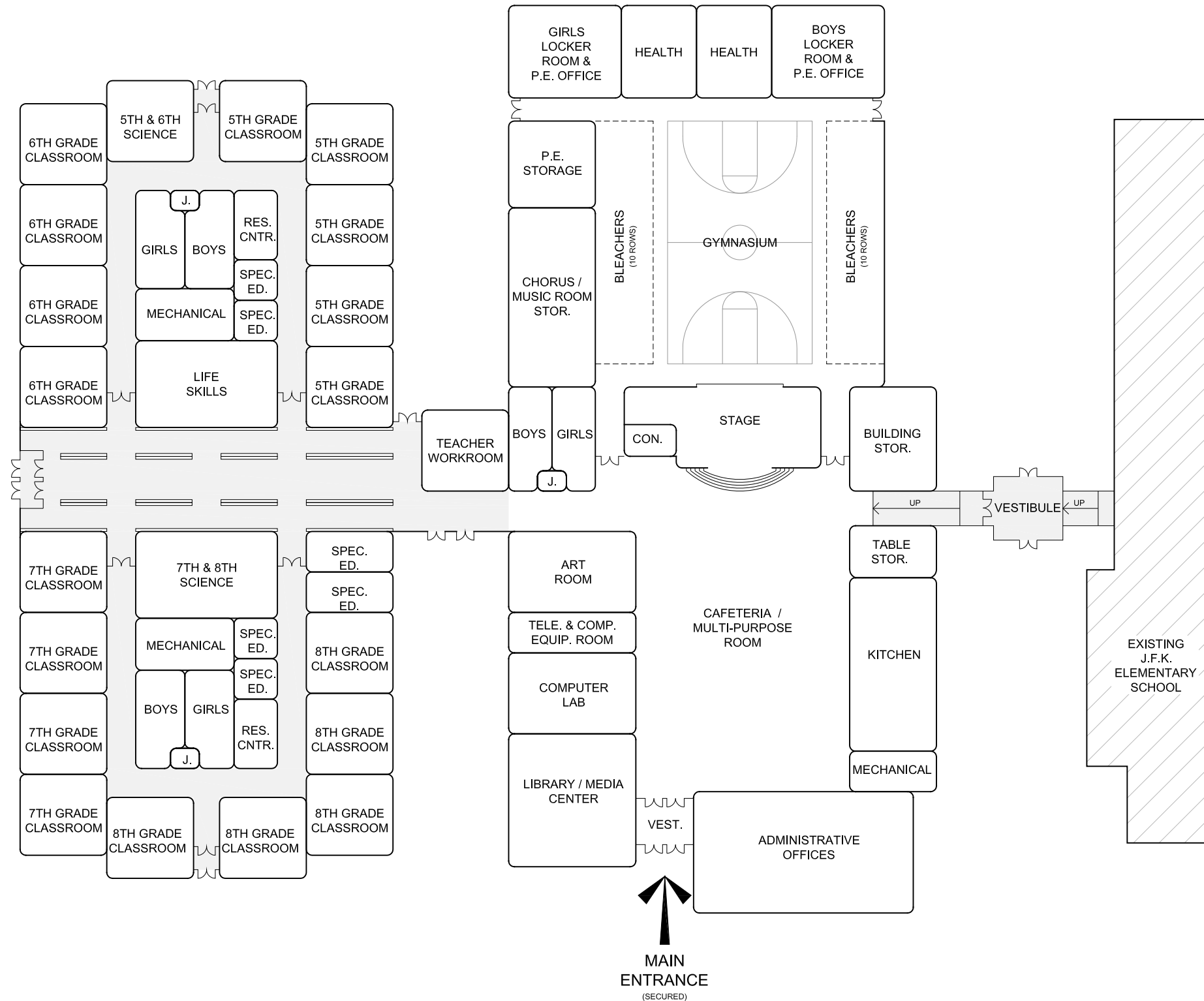

CONCEPTUAL DESIGN PHASE
FIRST FLOOR PLAN
SCALE: 1/16" = 1'-0"
NORTH

APPROVED CONCEPTUAL DESIGN
as per Board of Education action.
May 19, 2010

OPTION 'H-2'
79,600 S.F.

MAY 28, 2010

adc
Allied Design Consultants, Inc.
Architecture • Design • Planning
405 1/2 South Sixth Street
Springfield, Illinois 62701
217.522.3355 Fax 217.522.5570
alliedsn@tgi.net